

XTAR L4 Pro



+

Model	L4 Pro
Input	5V 2A
Compatible Battery Type	AA/AAA 1.5V Li-ion & 1.2V Ni-MH
Constant Charge Current	0.5Ax1 / 0.5Ax4
Charge Cutoff Voltage	1.5V Li-ion: N/A 1.2V Ni-MH: 1.45±0.1V
Charge Cutoff Current	1.5V Li-ion: ≤100mA 1.2V Ni-MH: N/A
Operating Temperature	0-40°C
Dimensions(mm)	L102 x W80 x H27.5
Net Weight(g)	87

Wide Compatibility, Independent Slot

- Supports all rechargeable AA/AAA Ni-MH and 1.5V Li-ion batteries.
- Charge 1 to 4 cells of different brands, capacities, sizes, and chemistries at once, no need to balance the load.



Smart & Accurate Detection for Safer Charge

L4 Pro will auto-detect the battery type and intelligently select the optimal charging method. It will show "Err" on the screen for the non-rechargeable or other mismatched rechargeable batteries.

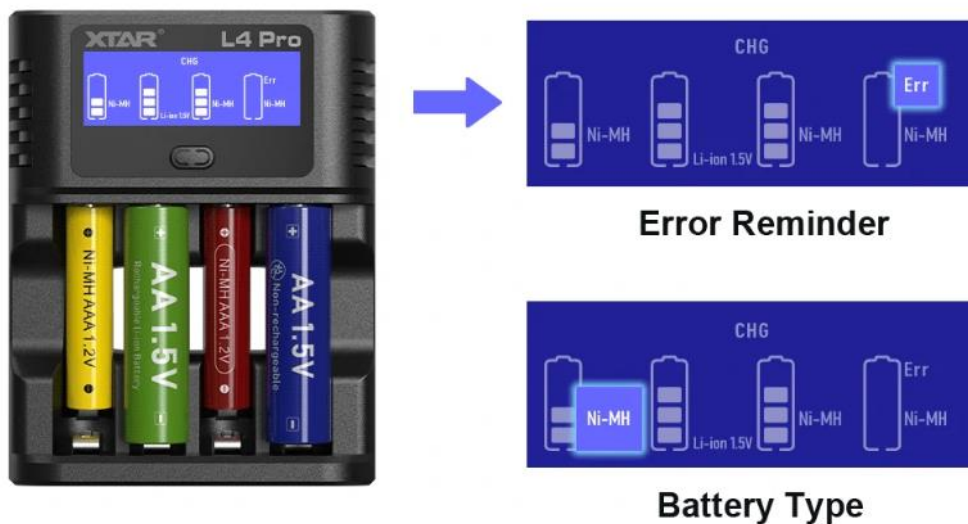

Fuller Charge, Lower Heat

- Our 5 methods of full-charge detection ensure that batteries are real fully charged.
- Unique CVSA tech enables lower body temperature of Ni-MH battery, ensures stable and fast charging, extending battery lifespan.

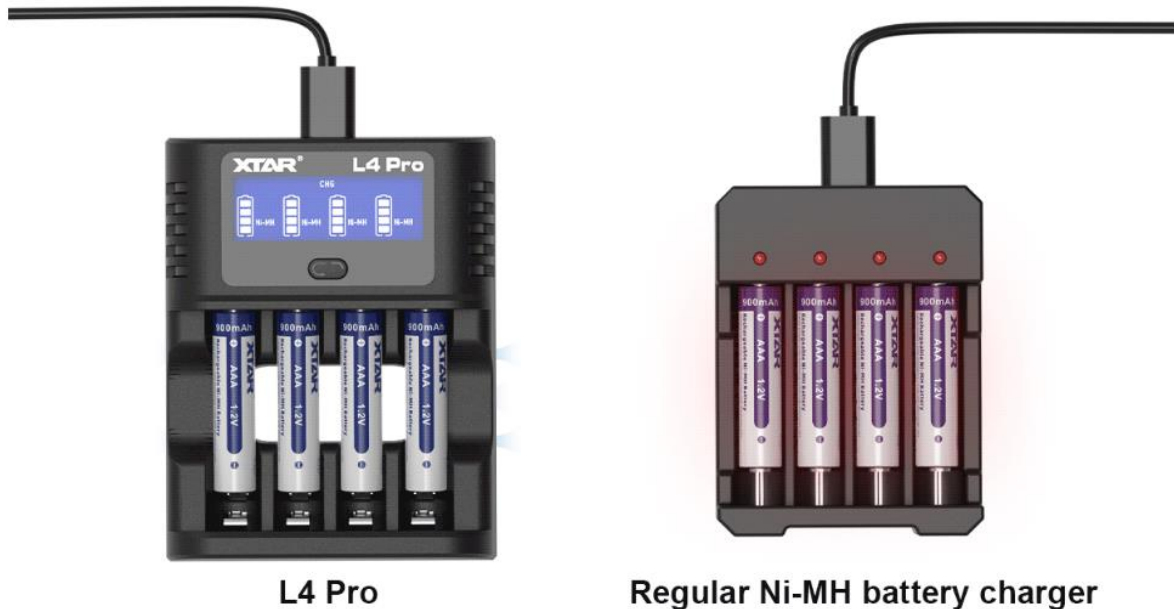

Maximize Old Battery Capacity with Refresh Mode

The reason for performing a Refresh is that older or frequently used Ni-MH batteries experience capacity loss and reduced performance. The Refresh will normally boost them back to their maximum possible capacity.

DisCHG Mode:

Daily and Quick Refresh

Ideal for batteries that are not too old. It performs a single discharge-charge cycle.

Refresh Mode:

Deep and Intelligent Refresh

Suitable for older or frequently used batteries. It intelligently adjusts the discharge-charge cycles based on the battery condition.



Long press the button to switch



DisCHG Mode

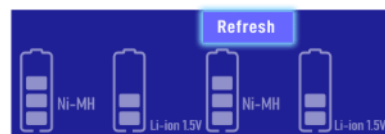

Refresh Mode

** Only for Ni-MH batteries, 1.5V Li-ion batteries will be auto-charged under this function.*

Easy-to-Read LCD Screen



* Charging Process: Battery level bars flash upward.
Discharging Process: Battery level bars flash downward.

Preventing Fire, Explosion, and Damage



Intelligent Detection



Timely Stop When Fully Charged



Over-Current Protection



Over-Charge Protection



Over-Voltage Protection



Short Circuit Protection



Reverse Polarity Protection



Soft Start

Compact Size for Easy Carrying

No burden in your bag, pocket, or on the go.

